

255 W. Riverview
NAPOLEON, OHIO 43545

message

reply

to: Harmon Sign Manufacturers, Inc.

Causeon,

Ohio 43567

subject Sign Permit # 11, Baum's Motel

FOLD

A field inspection has revealed that the minimum vert. distance between existing grade & the bottom edge of sign of 6 feet has not been complied with. We suggest your attention to this matter A.S.A.P.

S22 Beckham St.

date 5/13/74 signed R. H. Beckham

date _____ signed _____

SENDER: Mail white and pink copies with carbon intact. RECEIVER: Reply, retain white copy, return pink copy.

33990, Amsterdam Printing and Litho Corp., Amsterdam, N.Y. 12010



SIGN PERMIT

Owner's Name Daum's Motel

Address 522 Beekman St.

Builder Sharon Spina Address Wilmington, Ohio Tel. 419/395-2856

SIGN BILLBOARD AWNING MARQUEE

Location On the east side of Spina St approx 200' North of Beekman St. (To replace an existing sign) Wilmington

Dimensions 4' x 4' Square Feet 16

The minimum vert distance between existing grade & the bottom edge of sign shall be 6 ft. Wayne R. Zimmerman
Signature of Applicant

Application Must Be Accompanied with Sketch and Description of Proposed Installation

Permit No.	11
Issued	
By	
Estimated Cost	500.00
Base Fee	4.00
Add	0.00
Total Fee	4.00

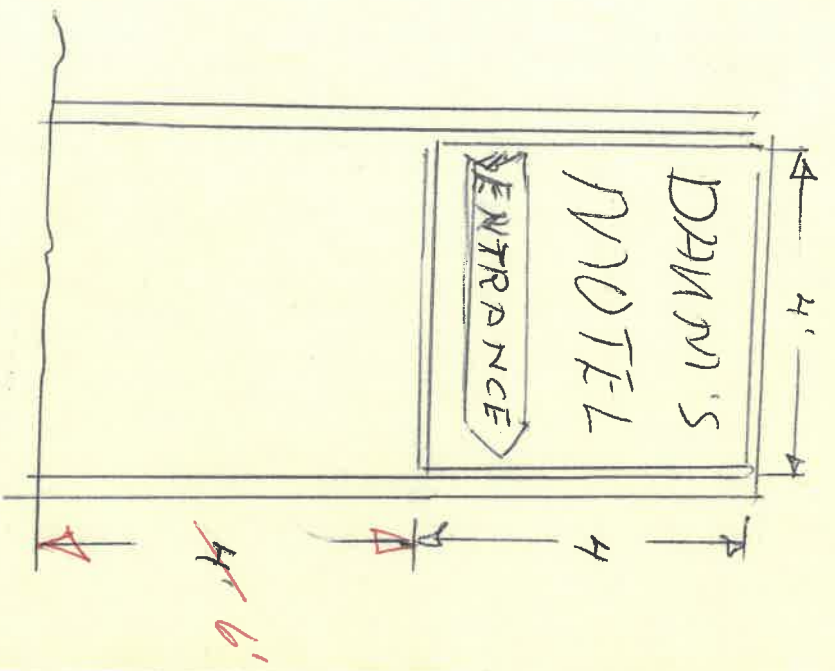

4' x 4' Plastic Illuminated

Dann's Motel
 522 Beckham St
 Mayastown, Ohio

